

grace
4 wheel stroller

instruction
MANUAL



Illustrations and designs may vary.

follow us on  [motherschoice.com.au](https://www.motherschoice.com.au)

the only choice

contents

assembling the stroller

Warnings	3
Components list	4
Opening stroller	5
Installing rear axle	6
Rear wheel assembly	6
Installing front wheel	7
Attaching bumper bar	8

using the stroller

Adjusting canopy	9
Adjusting backrest	10
Operating brakes	11
Operating footrest	12
Operating front swivel wheels	13
Folding stroller	14
Unfolding stroller	15
Carrying stroller	16
Harness adjustment buckle	17
Adjusting harness height	18
Tether strap	19

caring for your stroller

Care and maintenance	20
Notes	21
Product registration	23

contacts

Customer service	24
------------------	----

These instructions detail the safe use, assembly and maintenance of your product. Please read these instructions carefully and ensure that they are followed at all times. Failure to do so could result in serious injury or death.



WARNING TO AVOID INJURY OR DEATH:

ALWAYS APPLY THE BRAKES WHENEVER THE STROLLER IS STATIONARY.

FOLLOW THE MANUFACTURER'S INSTRUCTIONS.

DO NOT LEAVE CHILDREN UNATTENDED.

SECURE THE CHILD IN THE HARNESS AT ALL TIMES AND ENSURE THAT THE SAFETY HARNESS IS ADJUSTED FIRMLY BUT COMFORTABLY TO THE CHILD'S BODY.

DO NOT CARRY EXTRA CHILDREN OR BAGS ON THIS STROLLER.

MAKE SURE CHILDREN ARE CLEAR OF ANY MOVING PARTS IF YOU ADJUST THE STROLLER, OTHERWISE THEY MAY BE INJURED.

TO AVOID INJURY ENSURE THAT YOUR CHILD IS KEPT AWAY WHEN FOLDING AND UNFOLDING THE STROLLER.

ENSURE THAT ALL LOCKING DEVICES ARE ENGAGED BEFORE USE.

Never leave safety harness connected when not fitted to a child in the stroller, as this may create loops that cause a strangulation hazard.

Never leave a child in the pram/stroller when ascending or descending stairs or escalators, or when travelling on others forms of transport.

Use the tether strap to prevent the stroller rolling away.

Do not allow children to stand on the seat or footrest.

Do not attempt to lift the stroller by the bumper bar.

Engage front wheel swivel locks when travelling on rough or uneven surfaces.

Regularly inspect all parts and locking devices, promptly replace worn out or broken parts.

Use only those accessories which are supplied by Dorel Australia and approved for use with this stroller.

To prevent the risk of the stroller catching fire, do not park it near an open fire, heater or barbecue.

Fingers or parts of the body could be injured when the stroller is being folded or unfolded. Please use caution when folding or unfolding the stroller.

This stroller has been designed for use on flat or gently slopped surfaces. Using this stroller on uneven or higher sloped surface may cause the stroller to become unstable and tip over.

Do not run or jog with this stroller.

The weight of the child using this stroller should not be more than **17kg** (approximately 4 years of age).

Shopping basket capacity should not be more than **3kg**.

Canopy pocket **0.5kg** (max).

grace

stroller

components list



- | | | |
|-------------------------------------|-----------------------------------|-------------------------------------|
| A Canopy | H Seat | Q Adjustable backrest |
| B Canopy visor | I Adjustable footrest | R Recline levers (x2) |
| C Tether strap | J Swivel lock (x2) | S Shopping basket |
| D Self locking storage latch | K Front wheel (x2) | T Brakes (x2) |
| E Bumper bar | L Viewing window | U Rear wheel assembly |
| F Harness pads (x2) | M Handle | i) Rear wheel (x2) |
| G Safety harness | N Folding locks (x2) | ii) Metal washer (x2) |
| | O Storage pocket | iii) Retaining cap (x2) |
| | P Zip for canopy extension | iv) Retaining cap cover (x2) |
| | | v) Hub cap (x2) |

grace stroller assembling stroller



Step 1: opening stroller

- If the stroller has a security tie, please remove it.
- Release the storage latch (Figure 1a).
- Lift the handle upwards away from the rear legs (Figure 1b).
- Continue this action until the frame is fully open.
- When you hear a “click”, the stroller is opened to its extent and locked (Figure 1c).



mother's choice tip...

Ensure that both the upper and lower frame locks have fully engaged before placing a child in the stroller.

grace

stroller

assembling stroller

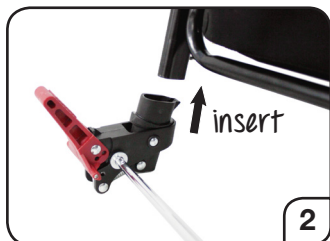

step 2: installing rear axle/brakes

- Insert the axle assembly into the rear stroller legs and push up until it snaps into place (Figure 2).

mother's choice tip...

Ensure red brake levers face towards the rear of stroller.

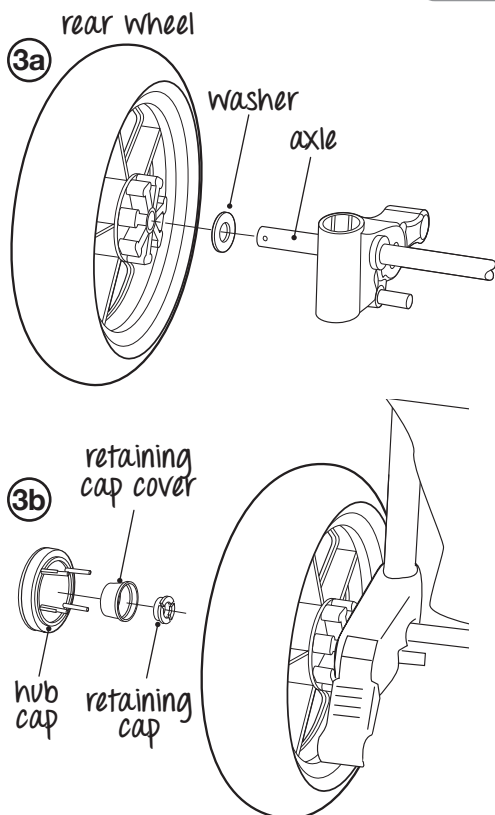

step 4: rear wheel assembly

- Ensure axle cover is removed before continuing.
- Slide the metal washer onto the axle, followed by one of the rear wheels (Figure 3a). Ensure the brake cogs are facing towards the axle.
- Attach the wheel retaining cap to the axle, and then the retaining cap cover (Figure 3b).
- Snap hub cap onto wheel (Figure 3b).
- Repeat steps to attach other wheel.

grace

stroller

assembling stroller

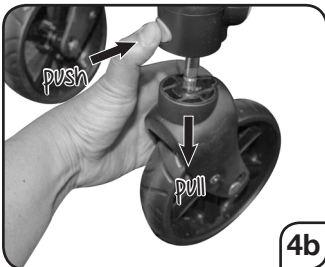
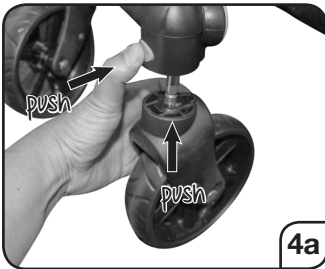

step 3: installing front wheel

- Align the shaft on the wheel with the hole in the front leg. Push in the button and simultaneously push the wheel into the hole (Figure 4a). Listen for a 'click'.
- Repeat for the other side.
- To remove the front wheel, push in the button inwards while pulling down on the wheel simultaneously (Figure 4b). Repeat for the other wheel.

grace stroller assembling stroller



Step 4: attaching/removing bumper bar

- Align the bumper bar with the frame of the stroller, ensuring the arrows located on the inside of the bumper bar are facing UP (Figure 5a).
- Push the bumper bar onto the frame. Ensure the clamps on either side of the bumper bar sit snugly below the folding bar in the area shown in Figure 5b.
- Push down on both clamps of the bumper bar simultaneously until they click firmly around the stroller frame (Figure 5c).
- To remove bumper bar, lift both clamps up and remove bumper bar (Figure 5d).

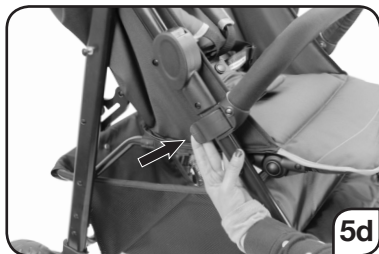
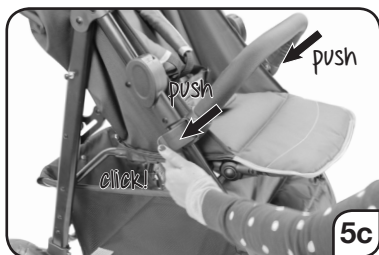

grace stroller using

to adjust canopy

- Pull the front edge of the canopy to open (Figure 6a, 6b).
- Unzip canopy zipper and pull canopy forward (Figure 6c).
- Flip out visor for extra coverage (Figure 6d).
- To close, simply push backwards.

mother's choice tip...

The canopy pocket maximum weight is 0.5kg.



grace stroller using stroller



upright

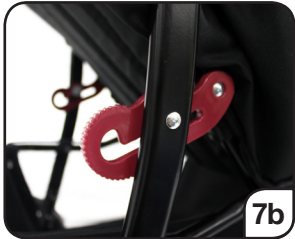

lowered



full layback

operating the backrest recline lever

- Recline the backrest by simultaneously adjusting the recline levers (both sides) into one of three positions, as demonstrated in Figures 7a - 7d. To adjust upwards, simply push on the backrest.



CAUTION

Do not adjust the seat back position with the child in the stroller.



adjustable backrest

mother's choice tip...

The backrest can be adjusted into 3 different positions.

grace stroller using stroller



operating brakes

- To apply the brake, press down firmly on both brake pedals using the ball of your foot (Figure 8a).
- Ensure both sides are engaged.
- To release the brake, lift both brake pedals until the brakes have fully disengaged (Figure 8b).
- Ensure both sides are disengaged.



WARNING

Apply all brakes whenever you park the stroller.

grace stroller using stroller

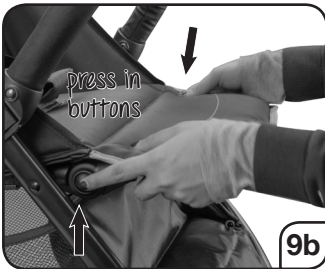

operating footrest

- The footrest's default position is down.
- To raise the footrest, simply lift upwards until the footrest 'clicks' into position (Figure 9a).
- Ensure both sides are engaged.

- To lower the footrest, push both adjustment buttons (Figure 9b) simultaneously and push down gently.

grace stroller using stroller

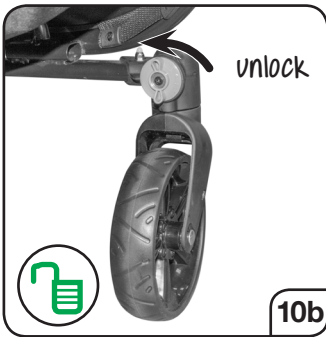

mother's choice tip...

Locked position is ideal for travel over rocky or uneven surfaces.

operating front swivel wheels

- To lock, turn the knob located above the front wheel anticlockwise until the indicator is horizontal (Figure 10a).
- To unlock, turn the knob clockwise until the indicator is vertical (Figure 10b).

grace stroller using stroller

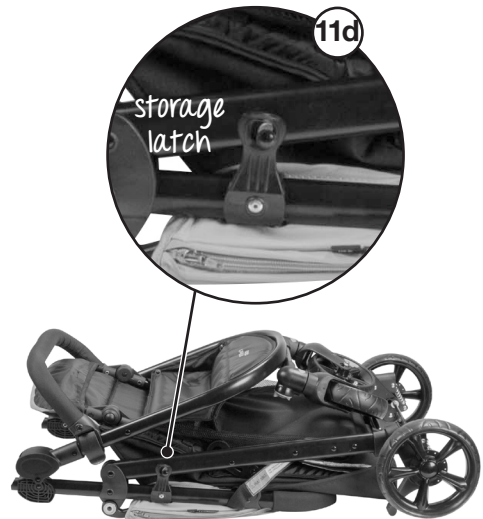

folding stroller

- Apply all brakes.
- Unlock the front swivel wheel.
- Fold the canopy back.
- Adjust the seat backrest to full layback position.
- Grip the folding locks on each side of the handle (Figure 11b), pull to release the lock.
- Press down on the handle to fold the stroller while pulling on the folding locks (Figure 11c).
- Ensure storage latch is engaged when stroller is fully folded (Figure 11d).

grace
stroller
using stroller

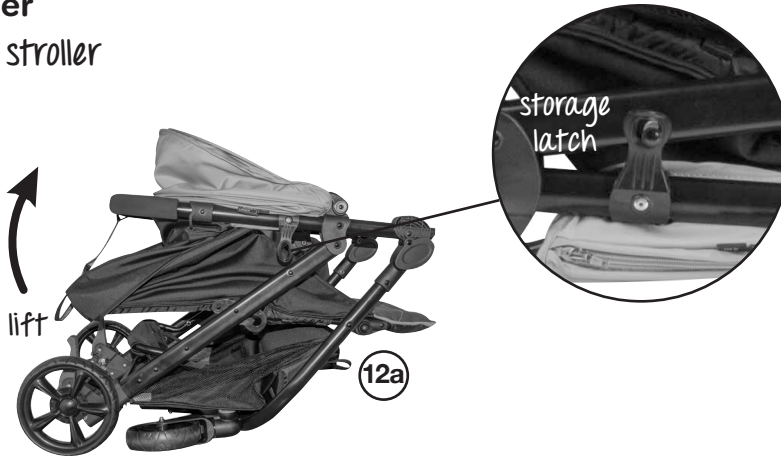

unfolding stroller

- Release the storage latch (Figure 12a).
- Lift handle until stroller is fully open and locking mechanism engaged (Figure 12b).
- Push down on the handle to check that the locks have been fully engaged.

Caution:

- Folding strollers and accessories will always have the potential to trap fingers or parts of the body between moving parts, causing injuries. Care should be taken while folding or unfolding.

grace stroller using stroller



carrying stroller

- Fold the stroller, and ensure that storage latch is applied before continuing.
- Carry stroller by holding frame between the storage latch and the folding lever (Figure 13). Avoid holding the stroller in other locations to avoid injury from moving parts.

grace stroller using stroller

securing your child

5 points of the harness can be adjusted by moving each straps' slider (figure A1).

To tighten or loosen the waist and/or shoulder straps, hold and lift the plastic adjuster. Adjust straps to desired position. The waist strap needs to fit firmly around the child.

1. Slip one shoulder strap (A) over each shoulder and position crotch strap between legs (B)

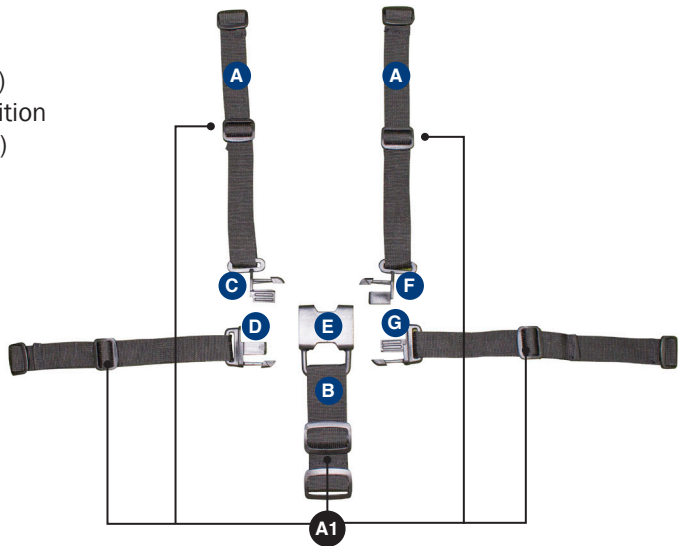

WARNING

Use this harness at all times.

A five-point harness is provided to secure your child.

When not in use disconnect shoulder straps from the waist strap buckle.

grace stroller using stroller

securing your child

2. Place buckle prong (D) on top of buckle prong (C)
3. Insert the prongs into the buckle housing (E) until it clicks into position. Repeat the above steps for the opposite side (F and G). Pull straps to ensure they are locked into the buckle assembly.
4. The harness should resemble this image.
5. The buckle is released by squeezing the top and bottom prongs together until harness disengages. (Figure 5).

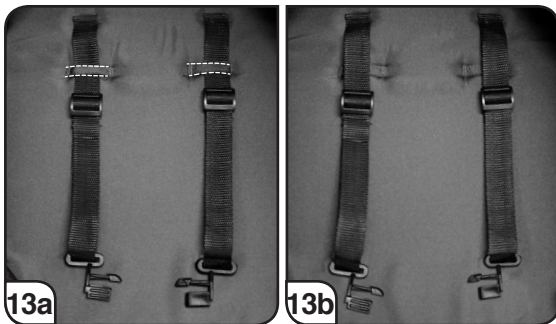
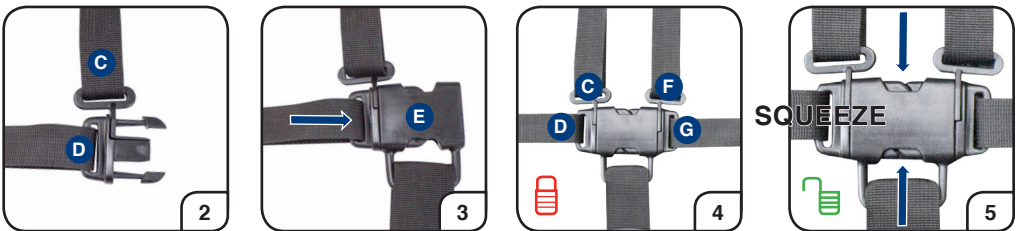

adjusting harness height

- To use the lower slot, undo the buckle and feed the shoulder straps in through the loop (Figure 13a) before securing harness.
- To use the upper slot, undo the buckle and feed both shoulder straps out through the loop (Figure 13b), and allow to hang over the loop before feeding through the seat pad and securing the harness.

grace

stroller

using stroller

tether strap

- Whenever a child is in the stroller and brakes are NOT engaged, the large loop should be around your wrist (Figure 14).

 **WARNING**
Use this strap to stop the stroller rolling away.

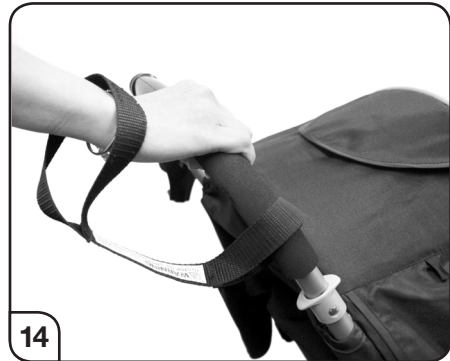

Note:

This vehicle is designed for use on flat or gently sloping surfaces and may be unstable on higher sloping and uneven surfaces. You should always be aware of the possibility of the stroller tipping on uneven or higher sloping surfaces.

grace

stroller

care and maintenance

- Always store in a clean and dry place.
- Clean the frame by wiping with a damp cloth.
- Do not use abrasives, bleach or strong detergents.
- Spot clean fabrics with warm water and mild soap.
- Ensure fabric is dry before storing.
- Occasionally clean and lubricate wheels and axles with a light lubricating oil.
- Regularly check for loose parts and tighten when required.
- Damaged or broken parts should be immediately replaced.

notes:

notes:

mother's choice tip...

Visit us online to register your new Mother's Choice product.



follow us on 
motherschoice.com.au

www.motherschoice.com.au/product-registration

benefits of registration

- Your safety - allows us to contact you with important product notifications.
- Confirmation of ownership - provides a record in case of product loss or theft.
- Improved product development - helps us continue to design products that meet your needs.

*to prevent loss or fading,
please attach your receipt here:*

motherschoice.com.au

DOREL AUSTRALIA PTY LTD
655-685 Somerville Road
Sunshine West Victoria 3020
Email: customerservice@dorel.com.au
Phone: 1300 809 526
Hours: 8:30 am - 5:00 pm Monday to Friday

IGC DOREL NEW ZEALAND LTD
14 Sir William Avenue
East Tamaki Auckland 2013
Email: customerservice@dorel.co.nz
Phone: 0800 628 000 (toll free)
Hours: 8:00 am - 5:00 pm Monday to Friday

017808 - Grace Stroller



#017808- Grace Stroller - 9/17

Specifications are subject to change without notice.
Copy or reproduction without permission is prohibited.
© 2017 Dorel Australia Pty Ltd. All Rights Reserved.

www.dorel.com.au