

AKAI

Makes Sense



46 Bottle Wine Fridge

INSTRUCTION MANUAL

MODEL: 46WF-AK

AFTER SALES SUPPORT
(AU) 1300 886 649 (NZ) 0800 836 761



E209

Contents

Page

- 03 General Safety Instructions
- 07 Installation
- 08 Product Overview
- 10 Getting Started
- 11 Instructions
- 15 Cleaning and Maintenance
- 16 Door Reversal
- 18 FAQs and Troubleshooting Guide
- 19 Other Useful Information

General Safety Instructions

READ CAREFULLY AND KEEP FOR FUTURE REFERENCE

Read this manual thoroughly before first use, even if you are familiar with this type of product. The safety precautions enclosed herein reduce the risk of fire, electric shock and injury when correctly adhered to. Keep the manual in a safe place for future reference, along with the completed warranty card, purchase receipt and carton. If applicable, pass these instructions on to the next owner of the appliance.



Pay particular attention to messages that follow this safety alert symbol or the words **DANGER**, **WARNING** or **CAUTION**. These words are used to alert you to a potential hazard that can seriously injure you and others. The instructions will tell you how to reduce the chance of injury and let you know what can happen if the instructions are not followed.



WARNING: Risk of fire

This symbol alerts you to take care as the appliance contains flammable materials: isobutane as refrigerant and cyclopentane as insulation blowing gas. While isobutane (R600a) is a gas with a high level of environmental compatibility, it is nevertheless flammable. Do not expose the appliance to high heat, sparks and open flames. During transport and installation, ensure that none of the components of the refrigerant circuit become damaged.

Refrigerant matters

WARNING: Do not damage the refrigerant circuit! Never use an appliance with a damaged refrigerant circuit! If the refrigerant circuit becomes damaged, avoid proximity to open fires and all types of heat and ignition sources. Thoroughly ventilate the room in which the appliance is located.

The room for installing the appliance must be at least 1m³ per 8g of refrigerant. The amount and type of refrigerant in the appliance can be found in the technical specifications on page 19 and on the appliance rating plate.

It is hazardous for anyone other than an authorised service person to service this appliance. In Queensland, the authorised service person **MUST** hold a Gas Work Authorisation for hydrocarbon refrigerants to carry out servicing or repairs which involve the removal of covers.

Responsible disposal

At the end of its working life, do not throw this appliance out with your household rubbish. Electrical and electronic products contain substances that can have a detrimental effect on the environment and human health if disposed of inappropriately. Observe any local regulations regarding the disposal of electrical consumer goods and dispose of it appropriately for recycling and recovery of the refrigerant and blowing agent. Contact your municipal authorities for advice on recycling facilities in your area.

WARNING! This refrigeration appliance contains flammable refrigerants and insulation blowing gases, which must be removed before disposal. Contact your municipal authorities for any codes or regulations concerning the disposal of such materials.

DANGER! Risk of child entrapment: When discarding this or another refrigerator, make sure to take off the door and leave the shelves in place so that children cannot easily climb in and get trapped inside.

General Safety Instructions (Cont.)

To reduce the risk of fire, electric shock or injury, always follow basic safety precautions and accident prevention measures when using this appliance, including the following:

Electrical safety

- **Voltage:** Before connecting and turning on the fridge, ensure the electrical voltage and circuit frequency correspond to those indicated on the appliance rating label.
- **Power connection:** This wine fridge must be connected to an exclusive, properly grounded 220-240 V~ 50Hz electrical outlet. Do not overload the electrical circuit.
- **Plug:** The power cord of this wine fridge is equipped with a three-prong plug for use in standard wall outlets to minimise the possibility of electric shock. Do not modify the cord and plug provided with the appliance. Improper use of the grounded plug can result in the risk of electric shock.
- **Power cord:** Do not kink or damage the power cord; do not leave it exposed or dangling. Secure it at the back of the appliance so no one steps on or places anything on the cord or against it. Keep the cord out of reach of children. When moving the appliance, make sure not to damage the power cord.
- **No inverter, adaptor or extension cord:** Do not use an inverter, adaptor or extension cord. If the cord is too short, have a qualified electrician install an outlet near the appliance. Use of an extension cord can negatively affect the performance of the unit.
- **Damaged cord:** Do not use a cord that shows cracks or abrasion damage along its length or at either end. Any damage to the cord may cause a short circuit, fire and/or electric shock. If the power cord is damaged, it must be replaced by the manufacturer or its service agent. Contact the after sales support line for advice.
- **Protect from moisture:** To protect against the risk of electric shock, do not immerse the unit, cord or plug in water or spray any other liquids on the appliance and parts. Do not connect or disconnect the electric plug when your hands are wet.
- **WARNING!** Never unplug the unit by pulling the cord. Always grip the plug firmly and pull straight out from the power point.
- **Electrical work:** If the installation of this appliance requires any electrical work, make sure it is carried out by a qualified electrician.

Usage conditions and restrictions

- **Domestic use only:** This appliance is intended for indoor household use only. It is not intended for commercial, industrial or trade use. Do not use it outdoors. Do not use it in a recreational vehicle.
- **Intended purpose:** Do not use this appliance for anything other than its intended purpose, and only use it as described in this manual. Do not attempt to alter or modify this appliance in any way.
- **Usage restrictions:** This appliance is not intended for use by persons (including children) with reduced physical, sensory or mental capabilities, or lack of experience and knowledge, unless they have been given supervision or instruction concerning the use of the appliance by a person responsible for their safety.

General Safety Instructions (Cont.)

- **Children:** Supervise children to ensure they do not play with the appliance. Close supervision is necessary when any appliance is used by or near children. Never allow children to operate, play with or crawl inside the appliance.
- **Attachments:** The use of attachments not recommended by the appliance manufacturer/distributor may be hazardous.
- **WARNING!** Do not use any electrical appliances inside refrigeration appliances, unless they are approved for this purpose by the manufacturer.

WARNING: This is a wine fridge, this is NOT to be used to preserve or store fresh food or consumables.

A wine fridge is designed for the storage of bottles at a certain temperature that is particularly suitable for wine. **The temperature maintained in this wine fridge is too high for safe storage of perishable foods.**

Cleaning and maintenance

- **Disconnect:** Unplug the appliance before cleaning or servicing. Failure to do so can result in electric shock, injury or death. Do not connect or disconnect the plug when your hands are wet.
- **Flames:** Do not let open flames or ignition sources enter the appliance.
- **Flammable/explosive substances:** Never clean this appliance with flammable fluids. Do not store or use volatile, flammable or explosive substances such as aerosol cans with a flammable propellants in or close to this or any other appliance. The fumes can create a fire hazard or explosion.
- **Solvents:** Do not use solvent based cleaning agents or abrasives on the interior as these may damage or discolour the surfaces of the appliances.
- **WARNING!** Do not use mechanical devices or other means to accelerate the defrosting process, other than those recommended by the manufacturer.
- **Service/repair:** Do not attempt to repair, modify or replace any part of the appliance unless specifically recommended in this manual. Refer all other servicing to a qualified technician, or contact the after sales support centre for advice.
- **Liability:** Damage due to improper use, or repairs made by unqualified personnel will void your warranty. We assume no liability for any eventual damages caused by misuse of the product or noncompliance with these instructions.

General Safety Instructions (Cont.)

Important installation precautions

- **Heavy:** This appliance is heavy, take care when moving it. To avoid back or other injury, consider a two person lift or mechanical aid when installing it. Failure to do so can result in back or other injury.
- **Freestanding design:** This appliance is designed to be freestanding only and should not be recessed or built in.
- **WARNING: Ensure proper ventilation!** To ensure proper ventilation, keep any ventilation openings, in the appliance enclosure or in the built-in structure, clear of obstructions. Ensure that the ventilation openings are never blocked or covered. Never cover shelves with aluminum foil or any other material, which may prevent air circulation.
- **Clearances:** To allow for adequate air circulation around the appliance and prevent overheating, leave around 12–13cm of space between the back and sides of the wine fridge and make sure that the front of the unit is completely unobstructed.
- **Where to install the appliance:** Install the appliance in an area that meets the following requirements:
 - ☑ **Ambient temperature:** Choose a well ventilated area for the wine fridge with temperatures ideally between 22°C and 25°C. In ambient temperatures above or below this range, the unit's interior temperature may fluctuate.
 - ☑ **Floor surface:** The floor must be dry, sturdy, level and strong enough to support the unit when it is fully loaded.
 - ☑ For best energy efficiency install the wine fridge in the coolest area of the room.
- **Where NOT to install the appliance:** Do NOT install the wine fridge in the following locations/situations:
 - ☑ In a garage or any other outdoor installation. The appliance must be installed in an indoor area protected from wind, rain, water spray or drips.
 - ☑ In an area with excessive moisture and high humidity. Excessive moisture in the air will cause fast build-up of frost on the evaporator.
 - ☑ In a recreational vehicle, or for use with an inverter.
 - ☑ In direct sunlight, near heat sources, next to an open flame, cooking or heating appliance (stove, heater, radiator, etc.), or near any other source of high heat. Direct sunlight may affect the acrylic coating and heat sources may increase the unit's power consumption.
 - ☑ In an area with extremely cold ambient temperatures.
 - ☑ In an area where petrol or other explosive and/or flammable liquids or fumes are used or stored. The fumes can create a fire hazard or explosion.

Installation

Installation steps

- **Keep it upright:** Do not tilt the fridge more than 45° from upright when moving it.
- **Handle with care:** Do not apply force to any part such as the condenser or door.
- **Spacers:** If installing the wine fridge against a wall, we suggest you attach the two spacers (supplied in the instruction manual bag) to the back of the appliance in order to prevent it from touching the wall (see the illustration, below).

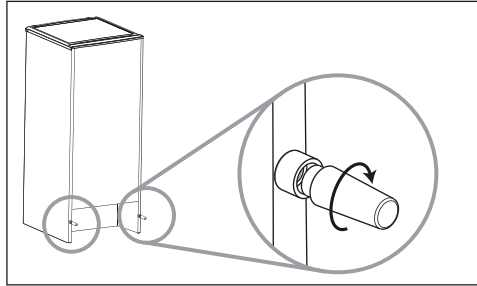

- **Levelling:** It is important for the wine fridge to be level in order to work properly. To level the unit, adjust the levelling legs at the front of the wine fridge.
- **Settling:** **Before connecting the wine fridge to the power source, let it stand upright for approximately 2 hours.** This will allow any refrigerant gasses that may have been disturbed during the transportation process to settle and reduce the possibility of a malfunction in the cooling system from handling during transport.
- **Electrical connection:** When all installation steps are completed, plug the wine fridge into a dedicated, properly installed wall outlet. Do not under any circumstances cut or remove the third (earth) prong from the power cord. Any questions concerning power and/or earthing should be directed toward a licensed electrician or our after sales support centre.

Product Overview



Scope of delivery

A Parts list

- 1 Operation and display panel (in the inner cabinet)
- 2 Tempered glass door
- 3 Front levelling legs (2x)
- 4 Bottom wine rack/basket C
- 5 Wine bottle shelf B (1x)
- 6 Wine bottle shelves A (5x)

B Documentation (not shown)

Instruction manual, Warranty certificate
(and 2 spacers for optional use)

NOTE: Due to continued product improvement, images and illustrations in this manual may vary slightly from the product purchased. All images in this manual are for reference purposes only. Parts are not necessarily pictured to scale.

Product Overview (Cont.)

Control panel

The control panel is located at the top of the inner cabinet. Open the door to access it.

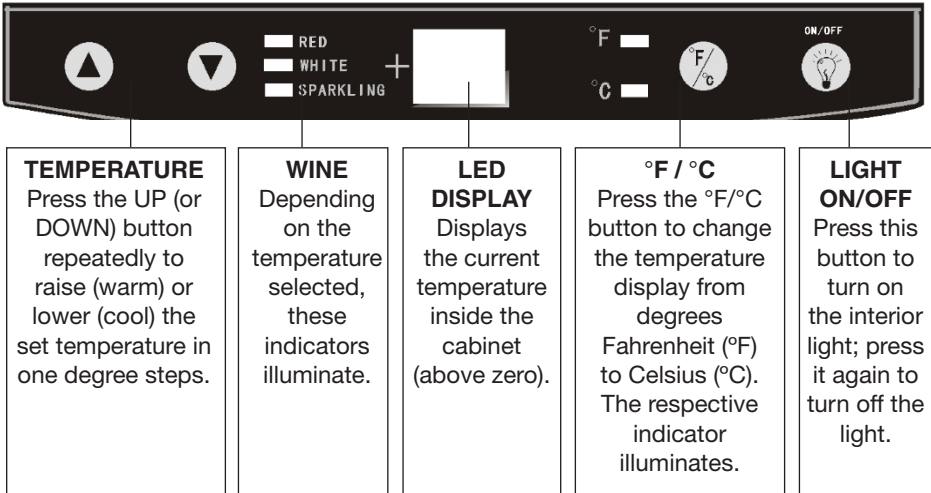

Getting Started

Unpacking

- **Packaging materials:** This product has been packaged to protect it against transportation damage. Remove all packaging materials from around and inside the appliance, including the protective foam on the door panels.
Keep the original packaging box and materials in a safe place. It will help prevent any damage if the product needs to be transported in the future, and you can use it to store the appliance when it is not in use. In the event that the box is to be disposed of, please recycle all packaging materials where possible.
Plastic wrapping can be a suffocation hazard for babies and young children, so ensure all packaging materials are out of their reach and disposed of safely.
- **Parts:** Check to ensure you have all the parts listed/pictured on page 8.
- **Power cord:** Unwind the power cord to its full length and inspect it for damage. Do not use the appliance if the appliance or its cord have been damaged or are not working properly. In case of damage, contact our after sales support centre for advice on examination, repair or return of the damaged product.
- **Read the manual:** Read this manual to familiarise yourself with the appliance. Pay particular attention to the safety instructions on the previous pages.
- **Clean:** To remove any dust from transit and storage, clean the interior surfaces of the wine fridge with lukewarm water and a soft cloth, following the instructions in the "Cleaning and Maintenance" section. Dry thoroughly.
- **Door opening:** Your wine fridge has the capability of the door opening from the right or left side. If your set-up requires reversal of the door swing, follow the instructions in the "Door Reversal" section. Your new wine fridge is now ready for installation.

First use

- **First cooling down:** When you first switch on the appliance, the compressor will run continuously until the wine fridge reaches a cool enough temperature. During this period of time, try not to open the door frequently or place bottles inside the appliance. After about 3–4 hours, you can start loading the wine fridge.
- **Odour:** You may notice an odour when you first switch on the appliance. This is due to the parts being new and is no cause for concern. The odour will subside as the appliance starts to cool.

IMPORTANT!

- When you use the wine fridge for the first time, or restart the appliance after it has been turned off for a long time, there could be a few degrees variance between the temperature you select and the one indicated on the LED display. This is normal and it is due to the length of activation time. Once the wine fridge has been running for a few hours, everything will be back to normal.
- When loading several bottles of wine at once, it will take longer for the appliance to cool the individual bottles than when adding a bottle at a time.
- If the unit is switched off or unplugged, you must allow at least 5 minutes before restarting the appliance or reconnecting it to your mains supply.



Instructions

Temperature control

This wine fridge enables you to store your wine in a stable temperature environment and free from light exposure and vibrations. These are most important factors when it comes to storing wine. A stable, temperature-appropriate environment will help maintain the quality of your wine and prevent spoilage.

- **Selecting the right temperature:** You can store your wine at the most appropriate serving temperature (see the table below). Set the temperature according to the type of wine that is mostly stored in the wine fridge.

Type of wine	Recommended storage temperature
Red wine	15.5° – 18.5°C
White wine	10° – 15°C
Rosé wine	9.5° – 10.5°C
Sparkling wine	7.2° – 9.5°C

- **Adjusting the temperature:** You can adjust the temperature in the cabinet to anywhere within the cooling range (7°C – 18°C). To set the temperature, press the UP  or DOWN  button repeatedly. With every press, the temperature will increase (or decrease) by one degree. The set temperature is shown on the LED display. Depending on the temperature selected, the “RED”, “WHITE” or “SPARKLING” wine indicators illuminate: **red** for red wine, **green** for white wine, or **amber** for sparkling wine.
- **Temperature display:** The temperature inside the cabinet can be displayed in either degrees Fahrenheit (°F) or degrees Celsius (°C). To change the display, press the °F/°C button. The respective indicator illuminates: **red** for °F, or **yellow** for °C.

Temperature variations

- The actual and set temperatures inside the cabinet may fluctuate slightly, depending on the storage location (lower, middle or upper section), and the frequency and duration of the interior light being on.
- There is a 4°C to 6°C temperature variance between the top and bottom shelves inside the wine fridge. So, if you are storing mainly red wine at 16°C, and want to add a few bottles of white wine, we recommend placing the white wine on the bottom shelves and the red wine in the upper section.

Instructions (Cont.)

Wine fridge capacity

Your wine fridge holds a maximum of 46 standard (750mL traditional Bordeaux-style) wine bottles. Storing wine in larger or differently shaped bottles may affect its storage capacity. Do not overload the cabinet, and only store wine in sealed bottles.

The loading diagram below (side and front view) shows how to fit the maximum number of wine bottles on the shelves; the photos on the next page give you a close-up view of the stacked shelves.

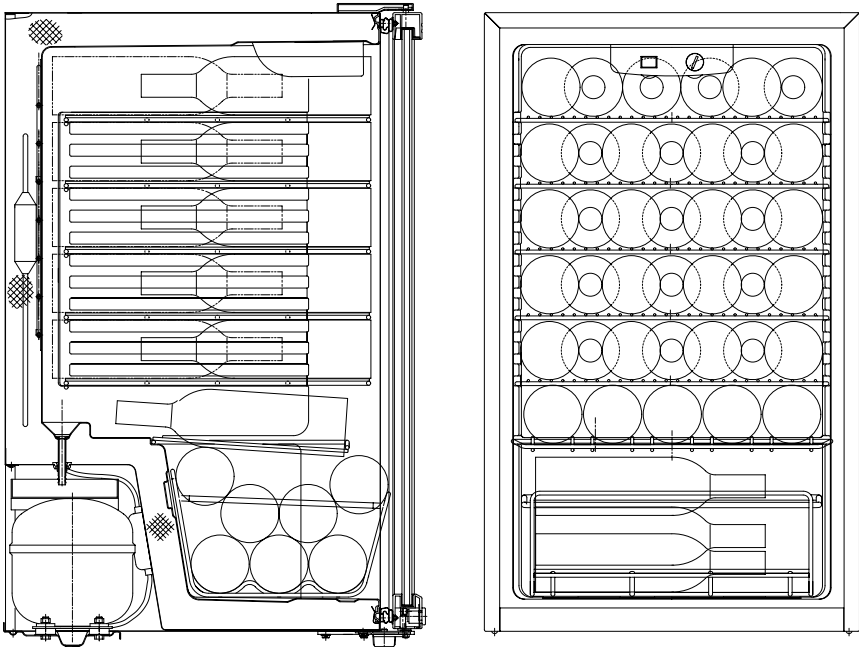

Shelf configuration

- The shelves may be configured to suit various wine bottle shapes and sizes. If storing larger bottles, make sure that they do not prevent the door from closing properly. Before shutting the door, always check that you can close it without bottles falling down inside the cabinet.
- Place the shelves on the shelf support rails with the curved and straight shelf wires at the front, as shown on the right (only the shelf coating is different in the picture, which does not affect storage capacity).
- For standard size bottles, use every third shelf support rail for the second to fifth shelf, as shown.

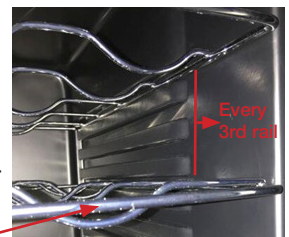

Instructions (Cont.)

Loading the wine fridge

Top shelf: 6 bottles

At the back: 4 bottles with necks towards the front.

At the front: 2 bottles with necks towards the back.



2nd to 5th shelf: 7 bottles per shelf

At the back: 4 bottles with necks towards the front.

At the front: 3 bottles with necks towards the back.



6th shelf: 5 bottles

At the front: 5 bottles with necks towards the back.



7th shelf (bottom rack/basket): 7 bottles

Three bottles at the bottom, 2 in the middle, 2 at the top, all facing the same direction, stacked as illustrated in the side view diagram on the previous page.



Instructions (Cont.)

Using the wine fridge

- **For efficient operation**, do not open the door unnecessarily. Only keep it open for as long as necessary when removing or adding a bottle.
- **For easy access to the bottles stored**, pull the shelves approximately one third out of the cabinet. Make sure the door is fully open when pulling out shelves to prevent damaging the door gasket.
- **For your viewing convenience**, the wine fridge has an interior light to help you check the contents. To activate the light, press the LIGHT  ON/OFF button on the control panel, then press the button again to switch off the light.
- **For best wine storage conditions**, always leave the interior light off during normal operation.

Power failure

- Most power failures are corrected within a few hours and should not affect the temperature of your appliance if you minimise the number of times the door is opened.
- If the power is going to be off for a longer period of time, take proper steps to protect the contents.

Going away?

- Leave the wine fridge operating during vacations of less than three weeks.
- If you are not going to use the appliance for longer periods, remove all items and unplug the power cord. Clean and dry the interior thoroughly. To prevent odours and mould growth, leave the door open slightly, blocking it open if necessary.

Moving the wine fridge

- To move the wine fridge, take all items out of the appliance, securely tape down the shelves and tape the door shut. Turn the levelling legs up to the base to avoid damage.
- Protect the outside of the wine fridge with a blanket or similar soft material.
- Make sure the wine fridge stays secure in the upright position during transportation.

Cleaning and Maintenance

WARNING!

Before cleaning the appliance, make sure it is disconnected from the power supply. Failure to do so can result in electric shock or injury.

Cleaning the wine fridge

- Take out any bottles as well as the shelves before cleaning.
- To remove a shelf, grip the shelf, lift it slightly and then pull it straight out of the cabinet, keeping it flat. To install the shelf at a different level, slide the shelf carefully into the appropriate groove.
- Wash the inside surfaces with a solution of lukewarm water (1L) and baking soda (2 tbsp). Use a soft, clean cloth to wipe down the surfaces, then rinse with clean water and dry with a dry cloth. Do not use soap or detergent for cleaning the cabinet.

NOTE: Wring excess water out of the cloth when cleaning around the controls or electrical parts.

- Make sure to keep the door gasket (seal) clean to keep the unit running efficiently.
- Wash the shelves and the outside of the cabinet with a mild detergent solution. Wipe dry with a clean soft cloth.
- It may also be necessary to periodically wipe the bottom part of the storage areas, as the wine fridge is designed to retain humidity, and condensation may collect there.

WARNING!

Never clean the unit with an abrasive, acid, oil or solvent based cleaning agent. Never use flammable fluids or sprays for cleaning as the fumes from these substances can create a fire hazard or explosion.

Automatic defrosting

The evaporator behind the rear wall of the unit defrosts automatically. The condensate collects in the drainage channel behind the rear wall of the unit and flows through the drainage hole into the drip tray by the compressor, where it evaporates.

Manual defrosting or emptying of the drip tray is not necessary.

Door Reversal

Reversing the door swing

The wine fridge has the capability of the door opening from either the left side or the right side to suit your individual installation requirements. The unit is delivered to you with the door opening from the left side (with the hinges on the right). If you want to reverse the opening direction, follow the instructions below.

WARNING!

- To avoid personal injury to yourself and/or damage to property, it is highly recommended that someone assist you during the door reversal process.
- Make sure the wine fridge is disconnected from the power supply when changing the side at which the door opens.

Door removal

Make sure the unit is disconnected from the power supply.

Tilt the unit backwards and secure it at an angle of 45 degrees.

Follow the illustration in Fig. 1, below, to remove the door. Keep all parts you remove from the appliance for installation of the door on the other side.

- Remove the upper hinge cover (6). Pull it straight up off the hinge. If it is difficult to remove, open the fridge door so you can get a better grip.
- Remove the three screws (1) that secure the upper hinge (5) (right side) to the frame, then remove the upper hinge (5).
- Lift the door, remove it from the lower hinge and place it on a padded surface to prevent damage and scratches.
- Remove the three screws (8) that hold the lower hinge and the front leg (2), then remove the lower hinge and the front leg (2).
- Remove the left front leg (4) and transfer it to the right side.

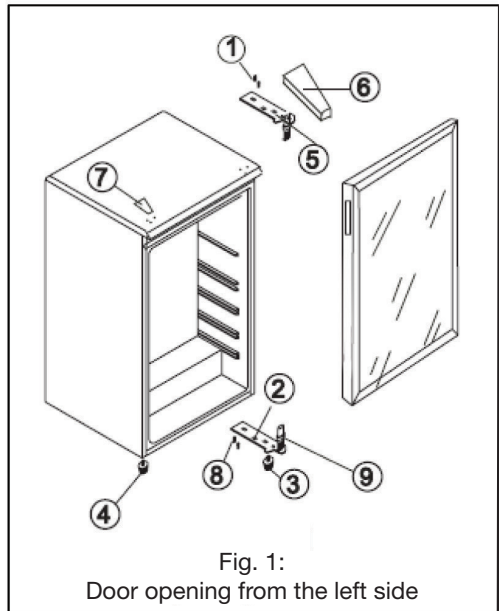

Door Reversal (Cont.)

Door installation

Follow the illustration in Fig. 2, below, to reinstall the door onto the other side, using the parts you removed earlier.

- Remove the hole cover plate (7) covering the upper hinge holes.
- Before replacing the lower hinge (2), remove the bolt pin (9) and reverse the direction of the lower hinge (2).
- Install the lower hinge and the front leg (2) onto the left side of the lower frame with the three screws (8).
- Insert the bolt pin (9) to the lower hinge (2).
- Secure the door onto the lower hinge.
- Holding the door in the closed position, secure the upper hinge (5) on the top left hand side with the three screws (1).
- NOTE:** Do not fully tighten the screws (1) until the top of the door is level with the top of the unit.
- Install the upper hinge cover (6) on the upper hinge.

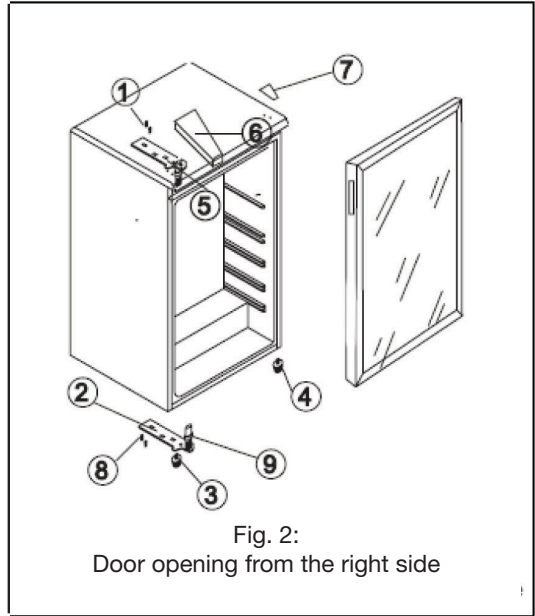

FAQs and Troubleshooting Guide

If you encounter any problems with your wine fridge, try the suggestions below to see if you can solve the problem before contacting our after sales support centre. You can solve many common problems easily, saving you the time of a possible service call.

Problem	Possible cause
The wine fridge does not operate.	<ul style="list-style-type: none"> • The appliance is not plugged in. • The home circuit breaker or fuse has tripped.
The wine fridge is not cold enough.	<ul style="list-style-type: none"> • Check the temperature control setting. Your external environment may require a higher setting. • The door is opened too often, or is kept open for too long. • The wine fridge has recently been disconnected for a period of time. Approximately 4 hours are required for the wine fridge to cool down completely. • The door is not closed completely.
The compressor turns on and off frequently.	<ul style="list-style-type: none"> • The room temperature is hotter than normal. • A large amount of contents has been added at a time. • The door is opened too often. • The door is not closed completely. • The temperature control is not set correctly. • The door gasket does not seal properly. • The wine fridge does not have the correct clearances.
There are vibrations.	<ul style="list-style-type: none"> • Check to ensure that the wine fridge is level. • If the wine fridge is touching the wall, reposition it.
The door will not close properly.	<ul style="list-style-type: none"> • The wine fridge is not level. • The door was reversed and is not properly installed. • The gasket is dirty. • The shelves are out of position.
Moisture forms on the inside fridge walls.	<ul style="list-style-type: none"> • The door is slightly open, causing cold air from inside the wine fridge to meet warm, moist air from outside. • The door is opened too frequently or kept open too long. • The door does not seal properly.
Moisture forms on the outside glass door.	<ul style="list-style-type: none"> • This may occur in summer or during high humidity, as a natural result of condensation. Just wipe it dry.
The wine fridge seems to make too much noise.	<ul style="list-style-type: none"> • Some noises are normal, such as a rattling or gurgling noise, which may come from the flow of the refrigerant. Contraction and expansion of the inside walls may cause popping or crackling noises. • The wine fridge is not level.
The light does not work.	<ul style="list-style-type: none"> • The appliance is not plugged in. • The home circuit breaker or fuse has tripped. • The bulb has burned out and needs to be replaced.

Other Useful Information

Service, repair and spare parts

- Do not attempt to alter or modify this appliance in any way. Do not attempt to repair or replace any part of the appliance unless it is specifically recommended in this manual. All other servicing should be referred to a qualified technician. Contact our after sales support centre for advice.
- If the light bulb needs to be replaced, please contact our after sales support centre to arrange for a service. The bulb must be replaced by appropriately qualified service personnel.
- Our after sales support centre stocks the following spare parts for the appliance:
 - Control PCB
 - Display PCB
 - Door gasket
 - Door hinge assembly (upper and lower)
 - Electrical box
 - Short adjustable foot
 - Temperature sensor
 - Wine shelf A (top to 5th shelf), B (6th shelf), C (bottom rack/basket)

To purchase a part, call the centre on (NZ) 0800 836 761 or email us at info@tempo.org.

Specifications and technical parameters

Dimensions	50cm (W) x 59cm (D) x 84cm (H)
Maximum capacity	46 standard 750mL bottles (Bordeaux-style)
Volume	117L gross, 115L net
Weight	32kg
Refrigerant	R600a, 24g
Temperature range	7°C–18°C
Rated voltage and frequency	220–240V~, 50Hz
Rated current	0.7A
Input power	110W

Compliance

This product has been fully tested and meets all requirements as set out by standards AS/NZS 60335.1 and AS/NZS 60335.2.24.

Warranty returns

Should you for any reason need to return this product for a warranty claim, make sure to include all accessories with the product.

Product does not work?

If you encounter problems with this product, or if it fails to perform to your expectations, make sure to contact our After Sales Support Centre on (AU) 1300 886 649 or (NZ) 0800 836 761 for advice.

For an electronic copy of this manual, please contact our after sales support centre.

Distributed by Tempo (Aust) Pty Ltd ABN 70 106 100 252

PO BOX 6056 Frenchs Forest, Australia NSW 2086

Customer Helpline:

(AU) 1300 886 649 (NZ) 0800 836 761

Email: info@tempo.org

V1.0 - July 2018

After Sales Support

☎ (AU) 1300 886 649 (NZ) 0800 836 761 | ✉ info@tempo.org