

shadow

shopping buggy

instruction MANUAL



Illustrations and designs may vary.

contents

<i>assembling the stroller</i>	<i>pg.</i>
Components list	4
Opening stroller	5
Lowering footrest	5
Fitting rear axle	6
Rear wheel assembly	6
Installing front wheels	7
Front swivel locks	7
Attaching child tray / Parent tray	8
 <i>using the stroller</i>	
Operating brakes	9
Folding stroller	10
Unfolding stroller	11
Carrying stroller	12
Adjusting backrest	13
Harness adjustment buckle	14
Adjusting harness height	15
Tether strap	16
 <i>caring for your stroller</i>	
Care and maintenance	17
Notes	18
Product registration	19
 <i>contacts</i>	
Customer service	20

These instructions detail the safe use, assembly and maintenance of your product. Please read these instructions carefully and ensure that they are followed at all times. Failure to do so could result in serious injury or death.



WARNING TO AVOID INJURY OR DEATH:

ALWAYS APPLY THE BRAKES WHENEVER THE STROLLER IS STATIONARY.

- **FOLLOW THE MANUFACTURER'S INSTRUCTIONS.**
- **DO NOT LEAVE CHILDREN UNATTENDED.**
- **SECURE THE CHILD IN THE HARNESS AT ALL TIMES AND ENSURE THAT THE SAFETY HARNESS IS ADJUSTED FIRMLY BUT COMFORTABLY TO THE CHILD'S BODY.**
- **DO NOT CARRY EXTRA CHILDREN OR BAGS ON THIS STROLLER.**
- **MAKE SURE CHILDREN ARE CLEAR OF ANY MOVING PARTS IF YOU ADJUST THE STROLLER, OTHERWISE THEY MAY BE INJURED.**
- A harness can form loops that may be a strangulation hazard, never leave harness straps connected when not fitted to a child in the stroller.
- Remove the child from the stroller before going up or down stairs or escalators.
- Use the tether strap to prevent the stroller rolling away.
- Do not allow children to stand on the seat or footrest.
- Do not attempt to lift the stroller by the bumper bar.
- Remove the child from the stroller before going up or down stairs or escalators.
- Engage front wheel swivel locks when travelling on rough or uneven surfaces.
- Regularly inspect the stroller for any parts that are loose, broken, torn or missing. Attend to the problem as soon as it is noticed.
- Use only those accessories which are supplied by Dorel Australia and approved for use with this stroller.
- Do not use the stroller near an open fire, barbecue or exposed flame.
- This product is not intended for commercial use.
- Do not run or jog with this stroller.
- The Shadow shopping buggy has been approved in accordance with AS/NZS 2088:2013.
- The weight of the child using this stroller should not be more than **17kg**.
- Shopping basket maximum weight **4kg**, Canopy pocket **0.5kg**, Parent tray **0.5kg**, and Child tray **1kg**.

shadow

shopping buggy

components list



- | | | |
|---------------------------------|-------------------------------------|----------------------------------|
| A Folding lock | H Large shopping basket | L Swivel wheel locks (x2) |
| B Handle | I Brakes (x2) | M Footrest |
| C Parent tray | J Rear wheel assembly | N Removable seat liner |
| D Tether strap | i) Hub cap (x2) | O Safety harness |
| E Storage pocket in hood | ii) Retaining cap cover (x2) | P Child tray |
| F Storage latch | iii) Retaining cap (x2) | Q Canopy |
| G Folding levers (x2) | iv) Rear wheels (x2) | R Window in canopy |
| | K Front wheels (x2) | |

shadow

shopping buggy

assembling stroller



Step 1: opening stroller

- If the stroller has a security tie, please remove it.
- Release the storage latch (Figure 1a).
- Lift the handle upwards away from the rear legs (Figure 1b).
- Continue this action until the frame is fully open.
- When you hear a “click”, the stroller is fully opened and locked.



Step 2: to lower the footrest

- Press down on the footrest until it snaps onto the cross bar (Figure 2).

shadow

shopping buggy

assembling stroller

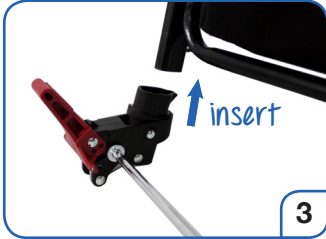

Step 3: installing rear wheels

- Insert the axle assembly into the rear stroller legs and push up until it snaps into place (Figure 3).

mother's choice tip...

Ensure red brake levers face towards the rear of stroller.

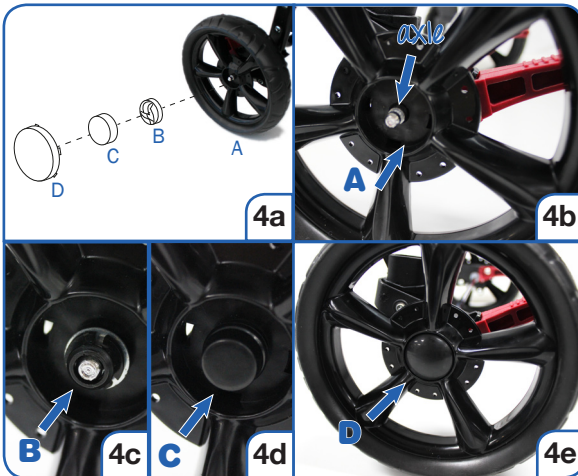

Step 4: rear wheel assembly

- Ensure axle cover is removed before continuing.
- With the spokes facing out, slide a wheel (A, Figure 4b) onto the axle.
- Insert the wheel retaining cap (B, Figure 4c), followed by the retaining cap cover (C, Figure 4d).
- Snap hub cap onto wheel (D, Figure 4e).
- Repeat steps to attach other wheel.

shadow

shopping buggy

assembling stroller



Step 5: installing front wheels

- Ensure that the arrow (Figure 5a) points upward.
- Also ensure that the red swivel lock is positioned correctly, with the lock facing in a forward direction (as per Figure 5c).
- Insert the front wheel assembly onto the frame tube (Figure 5d).
- The wheel assembly will “click” when installed properly.
- Repeat for other side.

operating front swivel locks

- To lock, align the swivel lock button with the frame and push upwards (Figure 5e).
- To unlock, push the swivel lock button downwards (Figure 5f).

shadow

shopping buggy

assembling stroller



step 6: attaching child tray

- Align both sides of the child tray with the frame, just below the folding joints.
- Push clamps down on both sides to lock (Figure 6a).



removing child tray

- To remove bumper bar, lift clamp on one side and pull other side off of the frame (Figure 6b).



step 7: attaching parent tray

- Fully extend the canopy.
- Place one side of the parent tray over the guiding pin on the frame above the canopy (Figure 7a), and push the other side of the parent tray down until it snaps onto the handle bar (Figure 7b).



shadow

shopping buggy

using stroller



operating brakes

- To apply the brake, press down firmly on both brake pedals using the ball of your foot (Figure 8a).
- Ensure both sides are engaged.
- To release the brake, lift both brake pedals until the brakes have fully disengaged (Figure 8b).
- Ensure both sides are disengaged.



WARNING

Apply all brakes whenever you park the stroller.

shadow

shopping buggy

using stroller



folding stroller

- Apply all brakes.
- Unlock the swivel wheels.
- Fold the canopy back.
- Adjust the seat backrest to full layback position.
- Press and pull folding lock on the back of the handle (Figure 9a) while pushing in secondary lock on the front of the handle (Figure 9b).
- Press down on the handle to fold the stroller while pulling on the folding locks (Figure 9d).
- Ensure storage latch is engaged when stroller is fully folded (Figure 9c).

press handle
downward



shadow

shopping buggy

using stroller



unfolding stroller

- Release the storage latch (Figure 10a).
- Lift handle until stroller is fully open and locking mechanism engaged (Figure 10b).
- Push down on the handle to check that the locks have been fully engaged.



Note:

- Folding strollers and accessories will always have the potential to trap fingers or parts of the body between moving parts, causing injuries. Care should be taken while folding or unfolding.

shadow

shopping buggy

using stroller

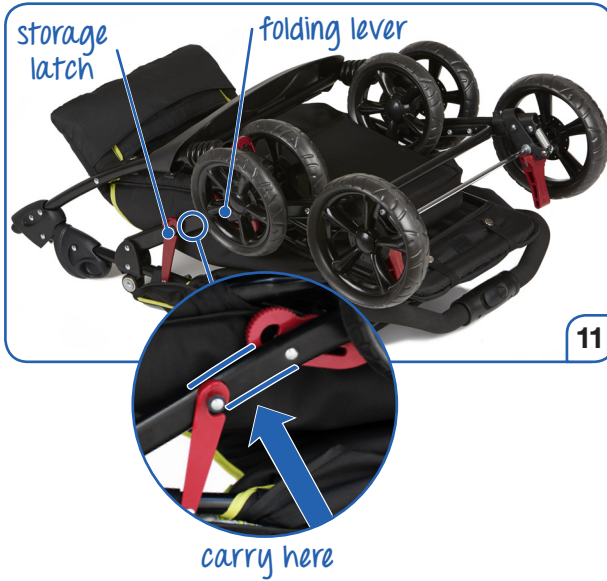

carrying stroller

- Fold the stroller, and ensure that storage latch is applied before continuing.
- Carry stroller by holding frame between the storage latch and the red folding lever (Figure 11). Avoid holding the stroller in other locations to avoid injury from moving parts.

shadow

shopping buggy

using stroller



upright

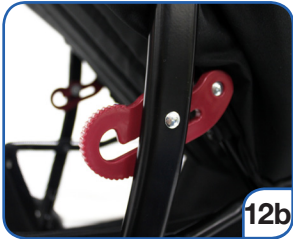

lowered



adjusting



full layback

operating the backrest recline lever

- Recline the backrest by simultaneously adjusting both red levers into one of three positions, as demonstrated in Figures 12a - 12d.



CAUTION

Do not adjust the seat back position with the child in the stroller.

mother's choice tip...

The backrest can be adjusted into 3 different positions.

shadow

shopping buggy

using stroller

harness adjustment buckle

- The harness strap can be adjusted by moving each strap's slider (A) (Figure 13a).
- The buckle is released by pressing the centre button (Figure 13b).



WARNING

Use this harness at all times.

A five-point harness is provided to secure your child.

When not in use disconnect shoulder straps from the waist strap and buckle.

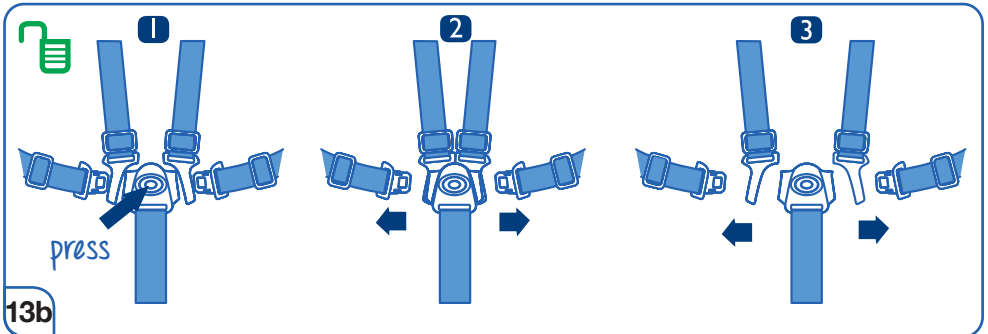
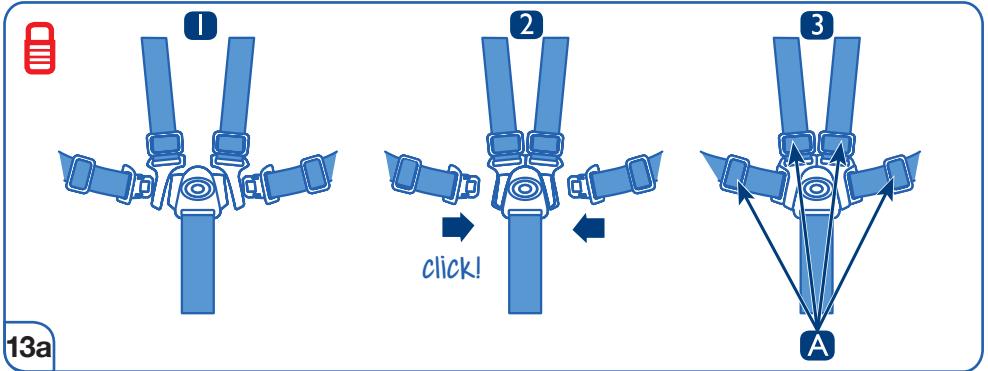

shadow

shopping buggy

using stroller

adjusting harness height

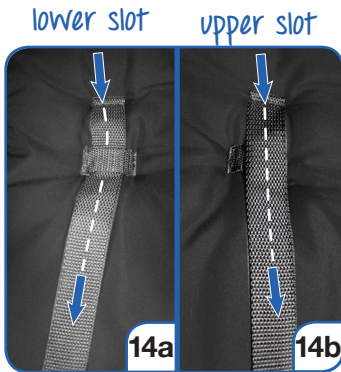

- The harness can be set at two heights, as displayed in Figure 14a and 14b.
- To use the lower slot, undo the buckle and feed the shoulder straps in through the loop (Figure 14c) before securing harness.
- To use the upper slot, undo the buckle and feed both shoulder straps out through the loop (Figure 14d), and allow to hang over the loop before feeding through the seat pad and securing the harness (Figure 14e).



lower slot use



upper slot use



mother's choice tip...

When harness is used in the lower slots, please make sure that the harness is fed as per Figure 14c.

shadow

shopping buggy

using stroller

tether strap

- Whenever a child is in the stroller and brakes are NOT engaged, the large loop should be around your wrist (Figure 15).



WARNING

Use this strap to stop the stroller rolling away.



15

Note:

- This vehicle is designed for use on flat or gently sloping surfaces and may be unstable on higher sloping and uneven surfaces. You should always be aware of the possibility of the stroller tipping on uneven or higher sloping surfaces.

shadow

shopping buggy

care and maintenance

- Always store in a clean and dry place.
- Clean the frame by wiping with a damp cloth.
- Do not use abrasives, bleach or strong detergents.
- Spot clean fabrics with warm water and mild soap.
- Ensure fabric is dry before storing.
- Occasionally clean and lubricate wheels and axles with a light lubricating oil.
- Regularly check for loose parts and tighten when required.
- Damaged or broken parts should be immediately replaced.

notes:

mother's choice tip...

Visit us online to register your new Mother's Choice product.



follow us on  
motherschoice.com.au

www.motherschoice.com.au/product-registration

benefits of registration

- Your safety - allows us to contact you with important product notifications.
- Confirmation of ownership - provides a record in case of product loss or theft.
- Improved product development - helps us continue to design products that meet your needs.

*to prevent loss or fading,
please attach your receipt here:*

motherschoice.com.au

DOREL AUSTRALIA PTY LTD
655-685 Somerville Road
Sunshine West Victoria 3020
Email: customerservice@dorel.com.au
Phone: 1300 809 526
Hours: 8:30 am - 5:00 pm Monday to Friday

IGC DOREL NEW ZEALAND LTD
14 Sir William Avenue
East Tamaki Auckland 2013
Email: customerservice@igc.co.nz
Phone: 0800 628 000 (toll free)
Hours: 8:00 am - 5:00 pm Monday to Friday

017010 - Shadow Shopping Buggy - 12 - 15



Specifications are subject to change without notice.
Copy or reproduction without permission is prohibited.
© 2015 Dorel Australia Pty Ltd. All Rights Reserved.

www.dorel.com.au