

# citrus

## layback stroller

instruction

# MANUAL



Illustrations and designs may vary.

follow us on    
 [motherschoice.com.au](http://motherschoice.com.au)

the only choice

# contents

<i>assembling the stroller</i>	<i>pg.</i>
Components list .....	4
Opening stroller .....	5
Front & rear wheels .....	6
Attaching canopy .....	7
<i>using the stroller</i>	
Peek-a-boo window .....	7
Folding stroller .....	8
Rear brakes .....	9
Front swivel wheels .....	9
Adjusting backrest .....	10
Tether strap .....	10
Securing your child .....	11
<i>caring for your stroller</i>	
Care and maintenance .....	12
Notes .....	13-14
Product registration .....	15
<i>contacts</i>	
Customer service .....	16

These instructions detail the safe use, assembly and maintenance of your product. Please read these instructions carefully and ensure that they are followed at all times. Failure to do so could result in serious injury or death.

---



## **WARNING**

- **FOLLOW THE MANUFACTURE'S INSTRUCTIONS.**
- **PUT ON ALL BRAKES WHENEVER YOU PARK THE STROLLER.**
- **DO NOT LEAVE CHILDREN UNATTENDED.**
- **DO NOT CARRY EXTRA CHILDREN OR BAGS ON THE STROLLER, UNLESS IT IS AN APPROVED ACCESSORY.**
- **MAKE SURE CHILDREN ARE CLEAR OF ANY MOVING PARTS IF YOU ARE FOLDING, UNFOLDING OR ADJUSTING THE STROLLER, OTHERWISE THEY MAY BE INJURED.**
- Secure the child in the harness at all times.
- Ensure that the safety harness is adjusted firmly but comfortably to the child's body.
- A harness can form loops that may be a strangulation hazard. Never leave harness straps connected when not fitted to a child in the stroller.
- Check that the stroller is fully erected and all safety locks are engaged before placing a child in the stroller, otherwise they may be injured.
- Do not allow children to stand on the seat or footrest.
- Do not attempt to lift the stroller by the bumper bar or child tray, if it has one.
- Do not run or jog with this stroller.
- Remove child from stroller before going up or down stairs or escalators.
- Do not use the stroller near an open fire, barbecue or exposed flame.
- Engage front wheel swivel locks when travelling on rough or uneven surfaces.
- This product is not intended for commercial use.
- Regularly inspect the stroller for any parts that are loose, broken, torn or missing. Attend to the problem as soon as it is observed.
- Use only those accessories which are supplied by Dorel Australia Pty Ltd and approved for use with this stroller.
- Use the tether strap to prevent the stroller rolling away.
- Keep children away from the stroller when unfolding and do not let them play with the folded stroller.
- The weight of the child using this stroller should not be more than **17kg**.
- Shopping basket capacity should not be more than **2kg**.
- Maximum weight for the rear canopy pocket is **0.2kg**.

# **citrus**

## **layback stroller**

### *components list*



**A** Handles  
(both sides)

**B** Upper frame lock

**C** Window & flap

**D** Canopy lock

**E** Tether strap

**F** Canopy pocket  
(not shown)

**G** Storage latch

**H** Shopping basket

**I** Backrest adjusters  
(both sides)

**J** Folding lock

**K** Lower frame lock

**L** Brakes  
(both sides)

**M** Rear wheels  
(both sides)

**N** Front wheels  
(both sides)

**O** Front wheel swivel locks  
(both sides)

**P** Footrest

**Q** Seat

**R** Safety harness

**S** Harness pads  
(both sides)

**T** Canopy

# citrus

## layback stroller

### assembling stroller

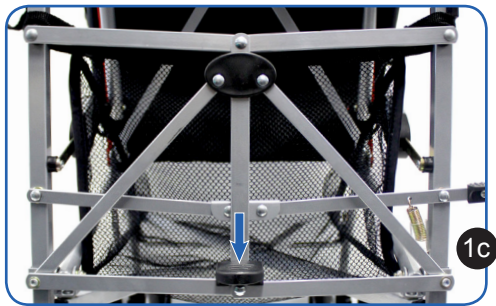

press down  
with foot



upper frame lock

### step 1: opening stroller

- If the stroller has a security tie, please remove it.
- Place the stroller on the floor with the handles facing downwards.
- Release the storage latch (Figure 1a).
- Lift the handle upwards away from the front legs (Figure 1b), while engaging the lower frame lock with foot (Figure 1c).
- Continue this action until the frame is fully open.
- Engage the upper frame lock by pressing it down into the locked position (Figure 1d).

#### mother's choice tip...

Ensure that both the upper and lower frame locks have fully engaged before placing a child in the stroller.

# citrus

## layback stroller

### assembling stroller



### step 2: attaching rear wheels

- Place stroller upside down.
- Align rear wheel assembly with rear legs of stroller, and push wheels on (both sides, Figure 2).
- Ensure the wheel assembly is locked by checking that the metal pin passes through hole in wheel assembly.

#### mother's choice tip...

To remove rear wheel assembly, push metal pin inwards with a pen to release lock, then pull wheel off.

### step 3: attaching front wheels

- Align the front swivel wheel assembly with the end of the front legs, making sure that the red arrow on the front of each wheel assembly points upwards toward the legs (Figure 3a)
- Press firmly to enable the plastic tab on each leg end to lock the assembly in place (both sides, Figure 3b.)
- Pull firmly on the wheel assemblies, to ensure that they have locked into place. Front wheel assembly should be able to swivel freely.

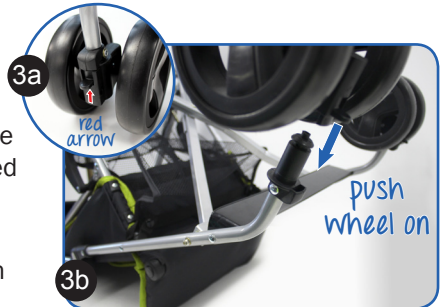

#### mother's choice tip...

To remove front wheel assembly, press the tabs in the end of the leg inwards and remove (Figure 3b).

# citrus

## layback stroller

### assembling stroller

#### step 4: canopy

- Fix canopy onto the stroller frame (both sides), attaching velcro (A) and clips (B and C) to frame (Figure 4a).
- Extend canopy out, and lock into place by pressing canopy lock down (Figure 4b).



#### using peek-a-boo window

- To reveal peek-a-boo window, ensure canopy is first fully extended.
- Lift flap from velcro tab (Figure 5a, 5b) and fold back.



# citrus

## layback stroller

### using stroller

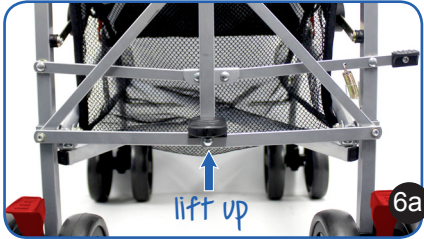

### to fold the stroller

- Apply all brakes.
- Remove all items in the shopping basket.
- Fold the canopy back.
- Unlock the swivel wheels.
- Lift the lower frame lock upwards (Figure 6a), then press down the folding lock (Figure 6b).
- Push the handle forward and down to fold the stroller. Disengage upper frame lock by pulling it upwards as stroller folds (Figure 6c).
- Continue this action until the stroller is folded.
- Attach the storage latch (Figure 6d).





# citrus

## layback stroller

### using stroller

#### operating rear brakes

- TO LOCK: Kick the brake lever downwards on each wheel (Figure 7a).
- TO UNLOCK: Push the brake lever upwards on each wheel (Figure 7b).

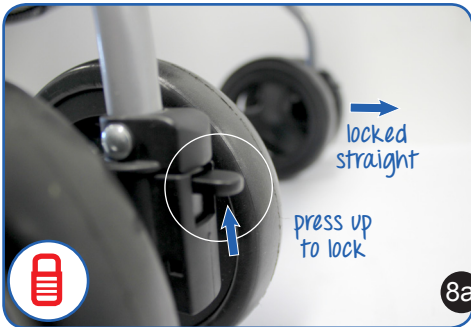

#### operating front swivel wheels

- TO LOCK: Push the swivel lock in the middle of the unit upwards in each wheel (Figure 8a).
- TO UNLOCK: Press the swivel lock downwards in each wheel (Figure 8b).



# citrus

## layback stroller

### using stroller

#### to adjust backrest

- To lower the backrest, hold the top of the backrest adjusters located on each side of the frame (Figure 9), then release the backrest to desired position.
- When positioning the backrest from the layback position to the sitting position, push the backrest upwards - there is no need to operate the adjuster lock.



backrest adjusters  
(both sides)

#### tether strap

- Whenever a child is in the stroller and brakes are NOT engaged, the large loop should be around your wrist (Figure 10).



## WARNING

Use this strap to stop the stroller rolling away.



# citrus

## layback stroller

### using stroller



### Securing your child

- The harness strap can be adjusted by moving each strap's slider.
- The buckle is released by squeezing the buckle tongues together.



## **WARNING**

Use this harness at all times.

A five-point harness is provided to secure your child.

When not in use disconnect shoulder straps from the waist strap and buckle.

# **citrus**

## **layback stroller**

### *care and maintenance*

- Always store in a clean and dry place.
- Clean the frame by wiping with a damp cloth.
- Do not use abrasives, bleach or strong detergents.
- Spot clean fabrics with warm water and mild soap.
- Ensure fabric is dry before storing.
- Occasionally clean and lubricate wheels and axles with a light lubricating oil.
- Regularly check for loose parts and tighten when required.
- Damaged or broken parts should be immediately replaced.







## mother's choice tip...

Visit us online to register your new Mother's Choice product.



follow us on    
[motherschoice.com.au](http://motherschoice.com.au)

[www.motherschoice.com.au/product-registration](http://www.motherschoice.com.au/product-registration)

## benefits of registration

- Your safety - allows us to contact you with important product notifications.
- Confirmation of ownership - provides a record in case of product loss or theft.
- Improved product development - helps us continue to design products that meet your needs.

*to prevent loss or fading,  
please attach your receipt here:*

motherschoice.com.au

DOREL AUSTRALIA PTY LTD  
655-685 Somerville Road  
Sunshine West Victoria 3020  
Email: [customerservice@dorel.com.au](mailto:customerservice@dorel.com.au)  
Phone: 1300 809 526  
Hours: 8:30 am - 5:00 pm Monday to Friday

IGC DOREL NEW ZEALAND LTD  
14 Sir William Avenue  
East Tamaki Auckland 2013  
Email: [customerservice@igc.co.nz](mailto:customerservice@igc.co.nz)  
Phone: 0800 628 000 (toll free)  
Hours: 8:00 am - 5:00 pm Monday to Friday

015468 - Citrus Layback Stroller - 09 - 14



Specifications are subject to change without notice.  
Copy or reproduction without permission is prohibited.  
© 2013 Dorel Australia Pty Ltd. All Rights Reserved.

[www.dorel.com.au](http://www.dorel.com.au)